

- 1: Determine Which Latch Position is Needed Looking at the Lock Side of the Handle**

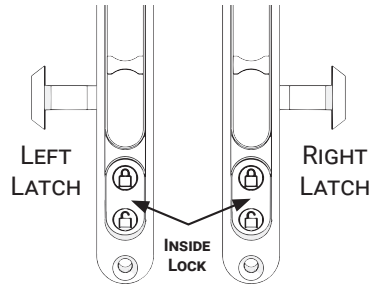

- 2: If Latch Configuration Needs To Be Changed, Please Refer to Samson Latch Configuration Instructions At www.SamsonPatio.com**

- 3: Install Door Seal**

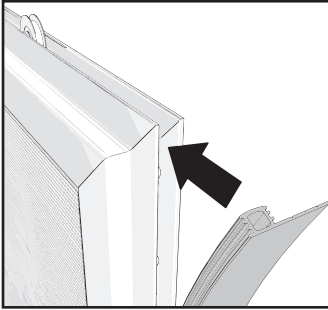

- 4: Tear Off For Proper Fit**

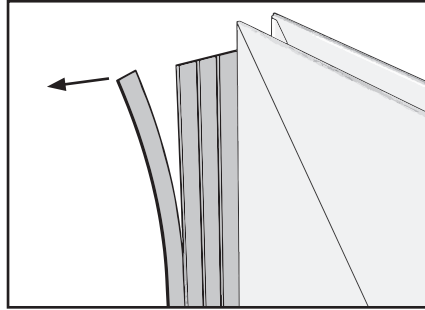

- 5: If Required, Install Anti-Rattle Pads**

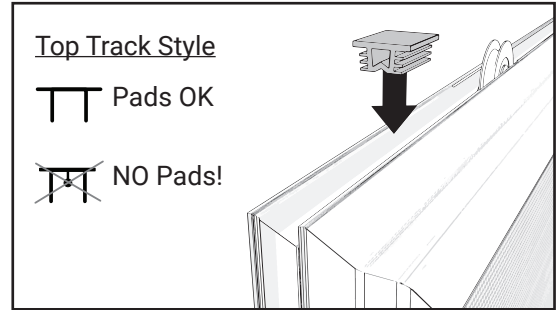

- 6: Be Sure All Rollers Are Retracted.**

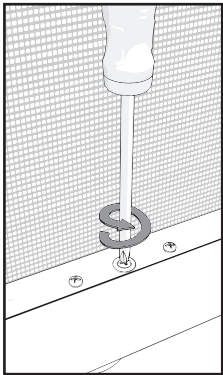

- 7: Insert Top of Door**

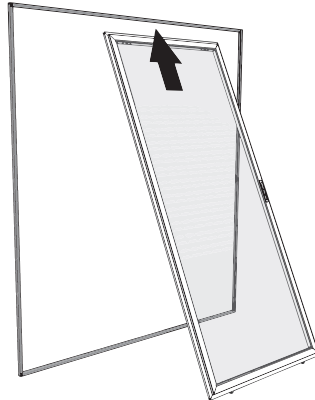

- 8: Position Bottom of Door. Raise Bottom Rollers (A) and Push in Bottom of Door (B)**

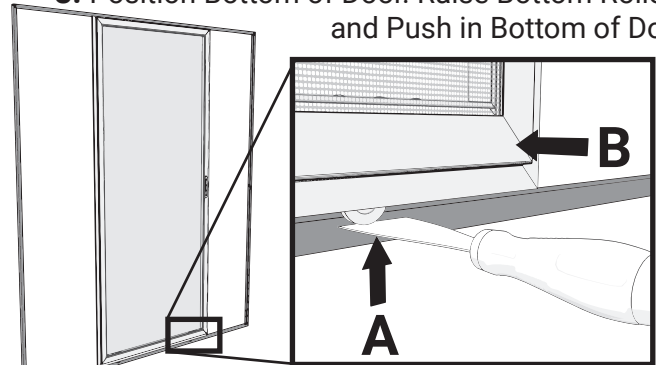

- 9: Adjust Rollers For Smooth Operation. Bottom Rollers Before Top Rollers**

- 10: Mark Bottom of Latch on Side of Door Frame**

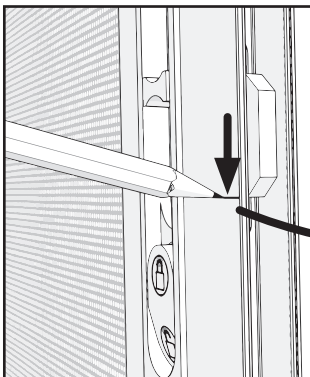

- 11: Transfer Mark To Jamb**

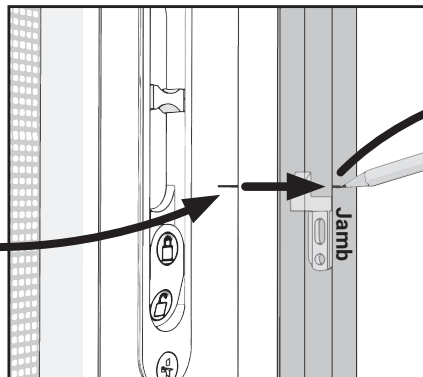

- 12: Measure Down 5/8" for Top Latch Screw**

