

Q50082 Iss: A 0312

**Aluminium Stile**  
When fitting lock to a new door stile at the desired height and cut out, drill both sides of the door stile to dimensions shown.  
**Important:** If replacing an old lock, the front cut out may require modification.

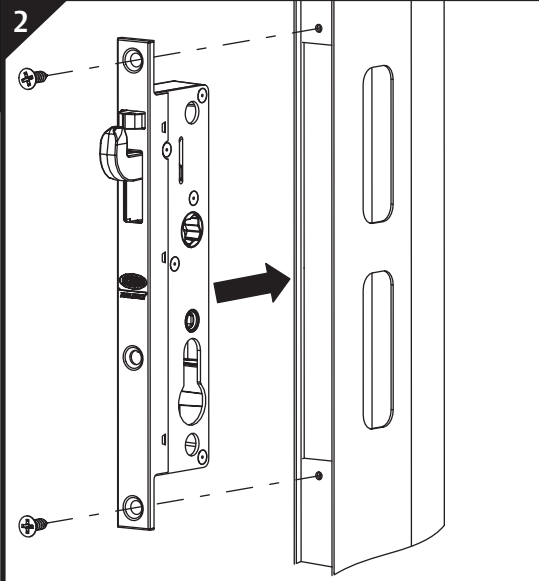

**Fitting Central Lock**  
With the central lock in the factory set **Deadlock** position, insert into the stile, then secure with screws.  
**Important:** The lock must be installed in the position shown, product warranty cannot be assured if installed upside down.

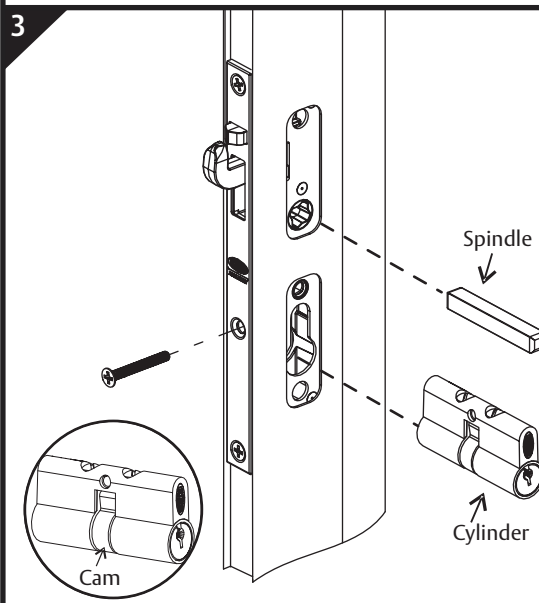

**Fitting Cylinder & Spindle**  
- Insert cylinder so cam turns towards front of door.  
- Loosely fix cylinder with screw.  
- Then insert spindle into lock body.

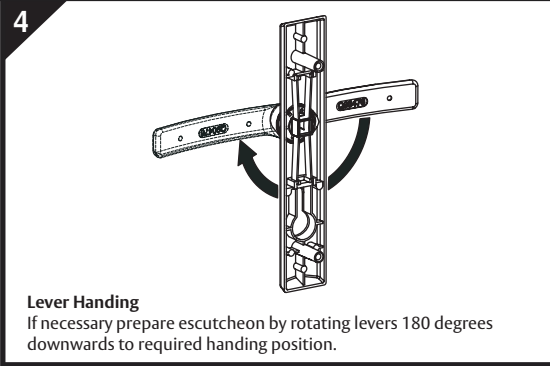

**Lever Handling**  
If necessary prepare escutcheon by rotating levers 180 degrees downwards to required handing position.

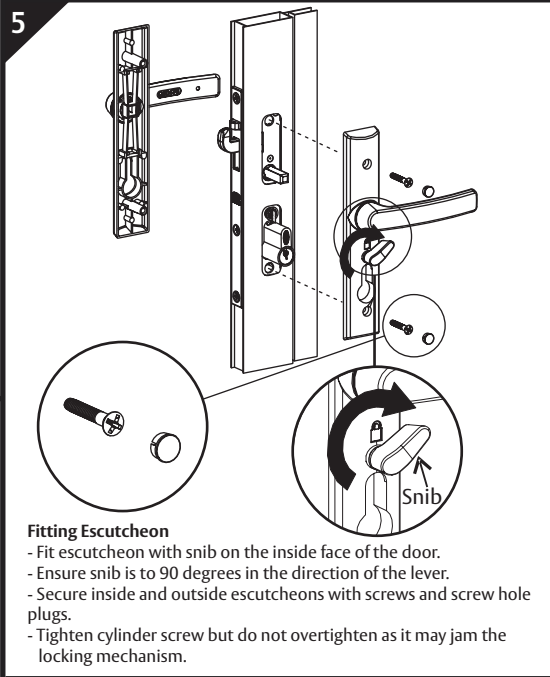

**Fitting Escutcheon**  
- Fit escutcheon with snib on the inside face of the door.  
- Ensure snib is to 90 degrees in the direction of the lever.  
- Secure inside and outside escutcheons with screws and screw hole plugs.  
- Tighten cylinder screw but do not overtighten as it may jam the locking mechanism.

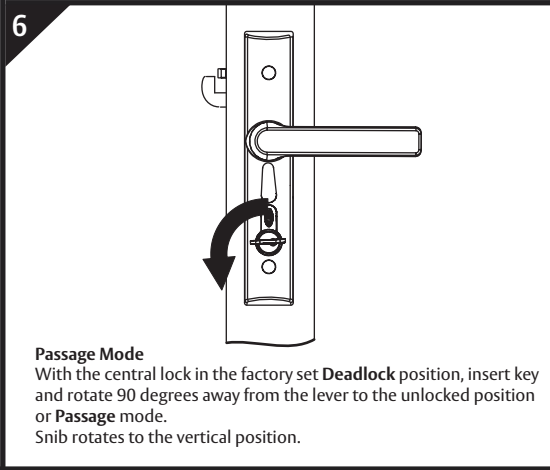

**Passage Mode**  
With the central lock in the factory set **Deadlock** position, insert key and rotate 90 degrees away from the lever to the unlocked position or **Passage** mode.  
Snib rotates to the vertical position.

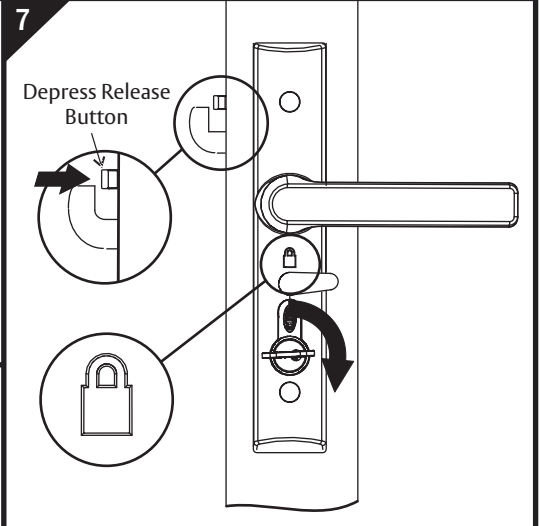

**Test Safety Mode:**  
**Important:** Release button above hook bolt must be depressed.  
**Rotate key or snib 90 degrees towards the lever:**  
- Padlock symbol is visible.  
- Inside and outside levers are locked.  
- Repeat **STEP 6** to return lock to **Passage** mode.

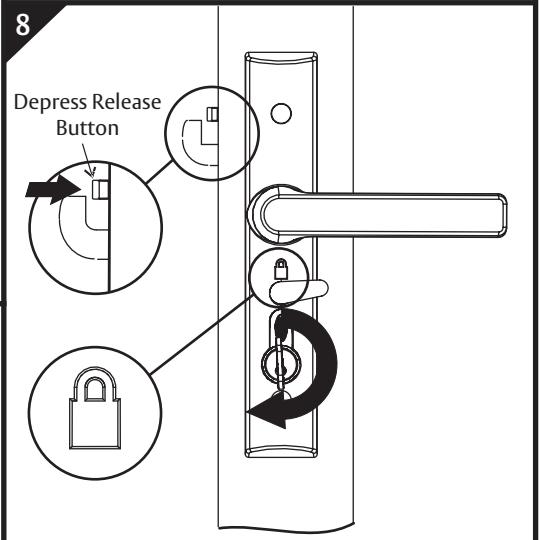

**Test Deadlock Mode:**  
**Important:** Release button above hook bolt must be depressed.  
**Rotate key 180 degrees towards the lever:**  
- Snib rotates 90 degrees towards the lever.  
- Padlock symbol is visible.  
- Inside and outside levers are locked.

9

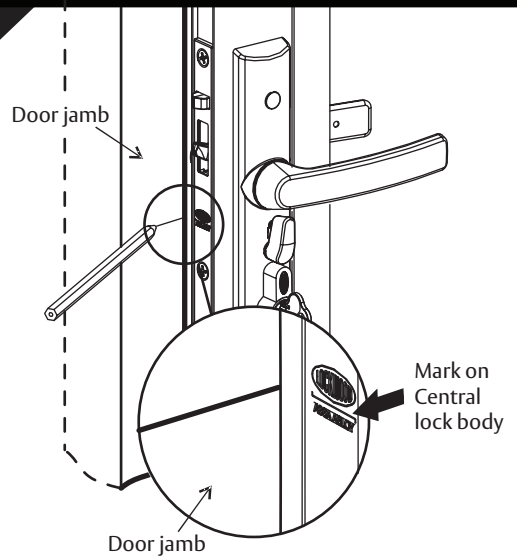

**Mark Central Strike Position**

Hold the door against the jamb and mark a line level with the mark on the front of the central lock body.

10

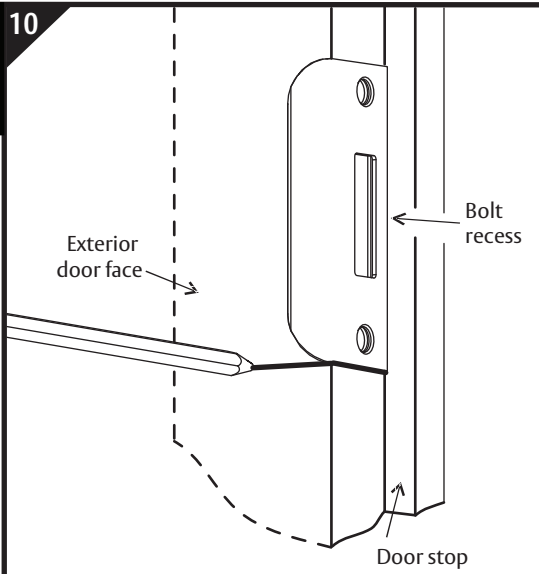

**Mark Bolt Recess and Screw Holes**

- Align the bottom of the central strike with the mark just made on the door jamb.
- Face the curved side of the strike outwards, hold strike against the door stop and mark bolt recess and screw hole positions.

11

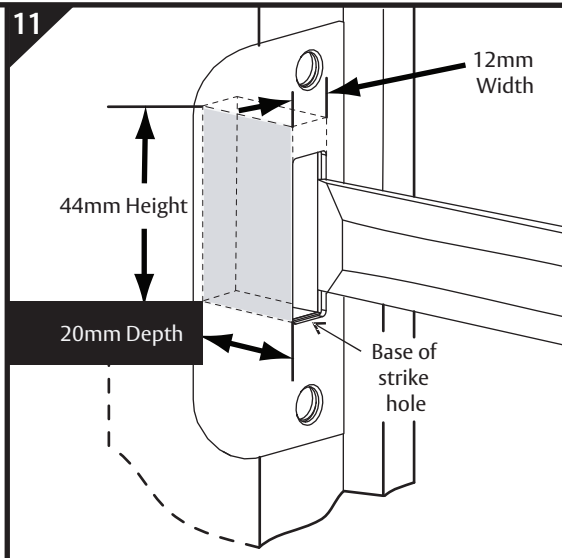

**Chisel Bolt Recess**

For timber door jambs chisel out bolt recess and ensure it is **at least 20mm deep** and 44mm high from the **BASE** of the strike hole.

12

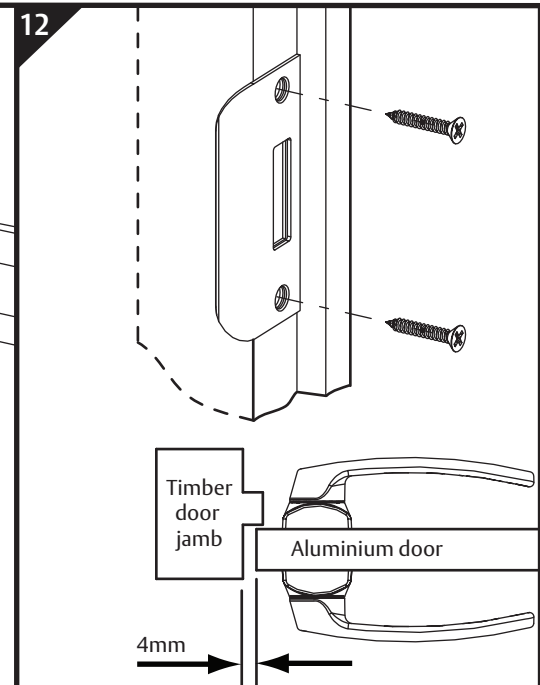

**Fix Screws**

- Secure the strike with fixing screws.
- Maximum clearance between door and jamb should **not exceed 4mm**.