



# PCA Enclosure Worksheet

Depending on the enclosure options selected this worksheet will assist you in determining the necessary information required to properly order your PCA screen door and enclosure accessories. Please use this worksheet in conjunction with PCA's Order Form.

This form can be used for both Single and Double Doors as well as One and Two Sided Side-Lite Kits

Dealer:	Job:	Date:
---------	------	-------

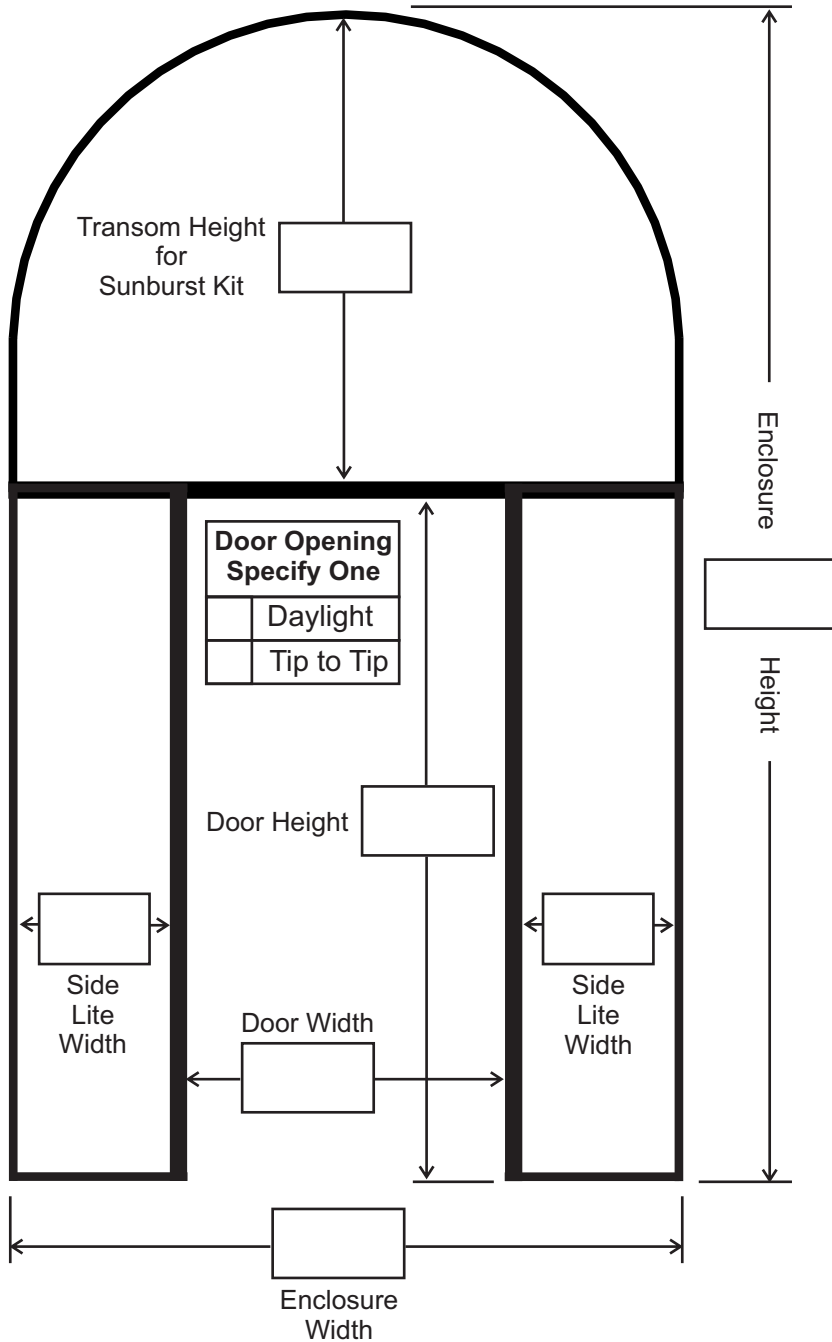

	Specify Items that Apply	Configuration	
		Single	Double
<b>1</b>	Screen Door		
<b>2</b>	Side Lite Kit		
<b>3</b>	Sunburst Kit (Transom Size):		
	Width = Enclosure Width		
	Height = Enclosure Height minus Door Height		

## Important Notes

### Screen Door Sizing

#### Daylight Opening

When using PCA's Installation Components please specify a Daylight Opening. PCA will make the necessary deductions to ensure proper fit. We encourage the use of PCA's Astragal with Double Door installations. If using another astragal along with PCA's Installation Components, please provide us the deduction required for your astragal.

#### Tip to Tip

When installing the door(s) with any other installation components such as an adjustable z-bar, full z-bar or 2x2 door jamb, please specify a Tip to Tip measurement. PCA will make NO Deductions.

### Side-Lite & Sunburst Kits

Kits ship unassembled with additional material to ensure proper fit. They will need to be trimmed to fit on site.

**Size restrictions apply to PCA's Screen Doors Side-Lite and Sunburst Kits depending on Series. Please consult sizing charts in Sales Catalog or at PCA's Dealer website prior to placing your order.**

<b>Special Instructions:</b>

Questions? We are here to help! Please call your local Distributor or PCA directly at 800-567-8897.